

Data sheet - Support roller STO 17TN (crowned, with inner ring)

Designation	STO 17
Type	crowned
D [mm]	40
d [mm]	17
F, Fw * [mm max.]	22
B1 [mm]	16
B [mm]	15,8
d1 [mm]	29
r [mm]	0,3
Dynamic load Crw [N]	14300
Static load C0rw [N]	17700
Speed limit [min-1]	5500

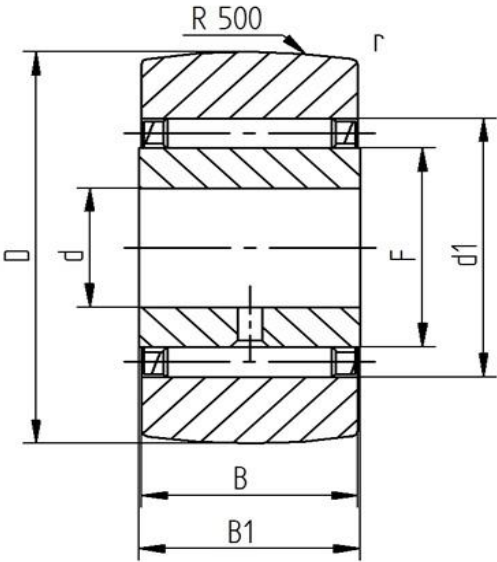

Every specification has been edited and verified carefully. STI Bearings GmbH assumes no liability for potential errors or incompleteness. Technical modifications are subject of changes.

© 2020 by STI Bearings GmbH

Reproduction, even excerpts, only with our approval.